

STOREYS



240 Kingsland Road, London, E2 8AT
Guide price £425,000



STOREYS

Floor Plan

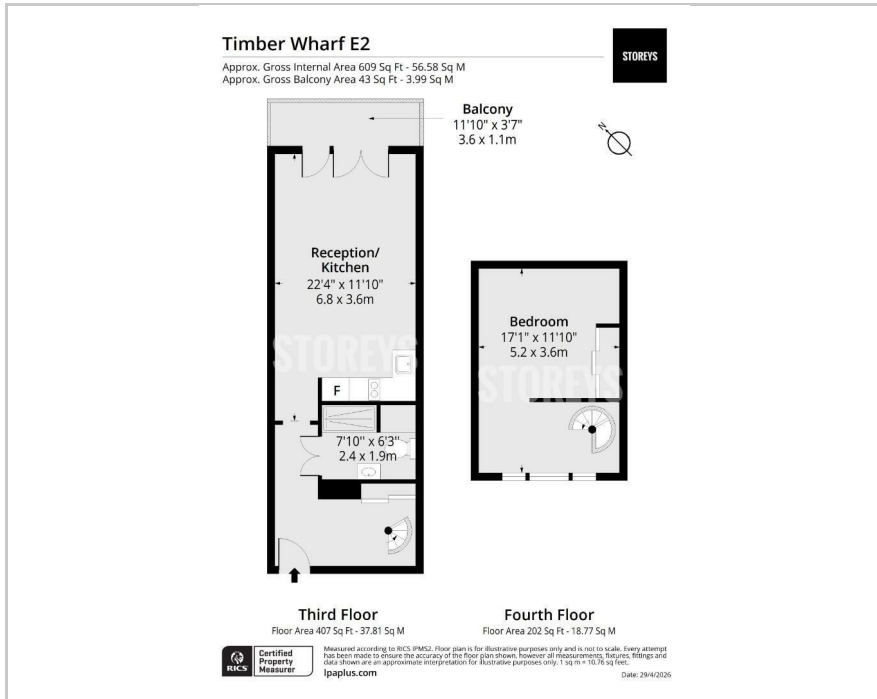

Area Map

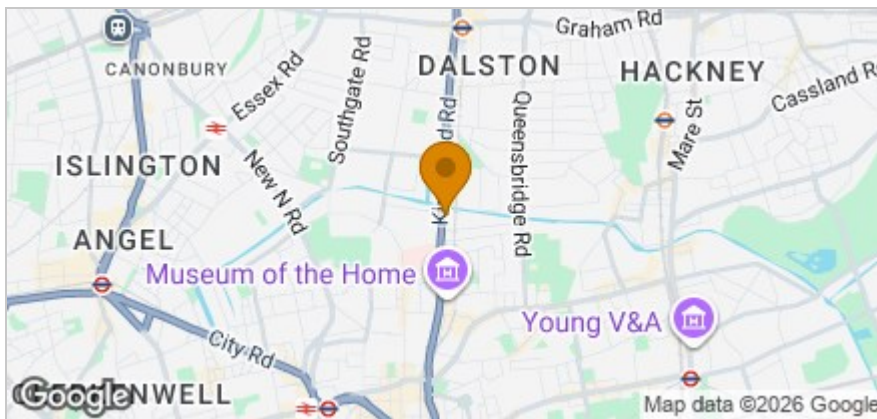

Accommodation

- Mezzanine Apartment
- Overlooking Regents Canal
- Set Within The Iconic Timber Wharf Development
- Moments From Broadway Market & London Fields
- Open Plan Living Space
- Private Canal-Facing Balcony
- Haggerston Station
- Secure Gated Development
- Characterful Spiral Staircase
- Chain Free

Viewing

Please contact our Storeys of London Office on 0207-096-0666 if you wish to arrange a viewing appointment for this property or require further information.

Energy Efficiency Graph

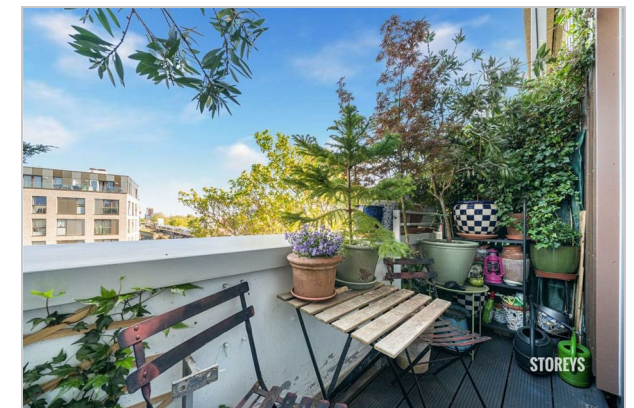
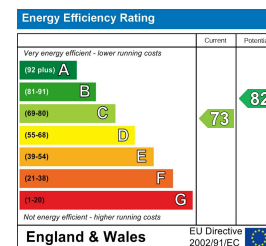

These particulars, whilst believed to be accurate are set out as a general outline only for guidance and do not constitute any part of an offer or contract. Intending purchasers should not rely on them as statements of representation of fact, but must satisfy themselves by inspection or otherwise as to their accuracy. No person in this firm's employment has the authority to make or give any representation or warranty in respect of the property.