

STOREYS

2008, 2, Cassia Point Glasshouse Gardens, London, E20 1HX
£2,250 Per month



1



1



1



B

STOREYS

Floor Plan

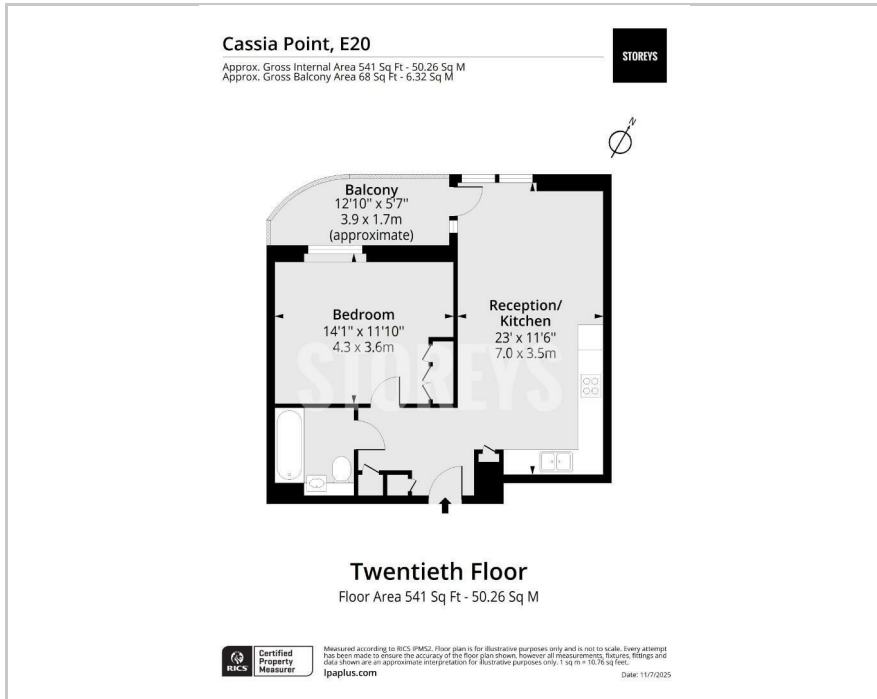

Area Map

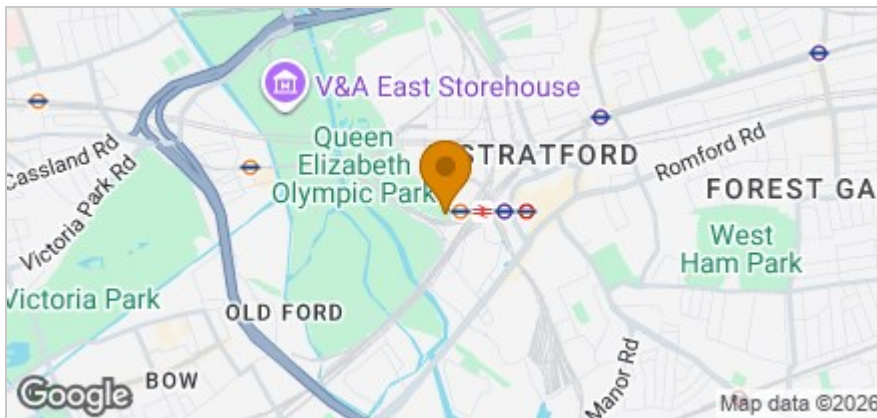

Accommodation

- Twentieth Floor
- Olympic Park E20
- Views Of Olymic Stadium
- Residents Gymnasium
- Concerige Service
- Stratford Internatinal Station
- Westfield Shopping Centre
- Open Plan Living Spcae
- Intergrated Kitchen
- Balcony

Viewing

Please contact our Storeys of London Office on 0207-096-0666 if you wish to arrange a viewing appointment for this property or require further information.

Energy Efficiency Graph

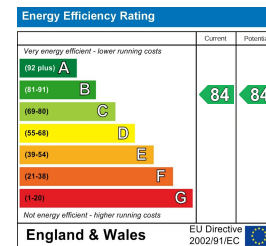

These particulars, whilst believed to be accurate are set out as a general outline only for guidance and do not constitute any part of an offer or contract. Intending purchasers should not rely on them as statements of representation of fact, but must satisfy themselves by inspection or otherwise as to their accuracy. No person in this firms employment has the authority to make or give any representation or warranty in respect of the property.