

STOREYS

45 Approach Road, London, E2 9LY
£3,000 Per month



STOREYS

Floor Plan

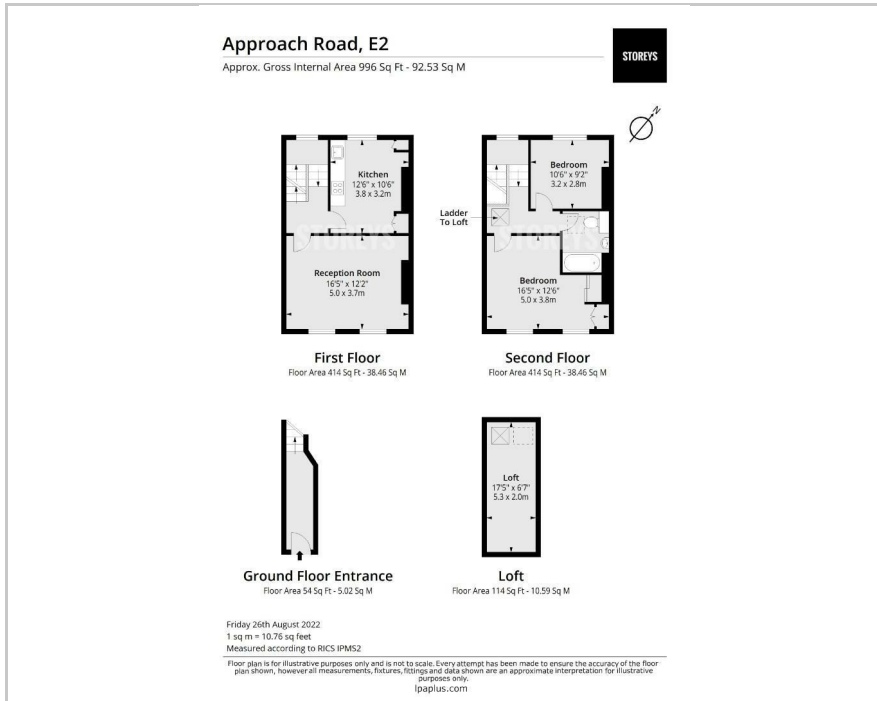

Area Map

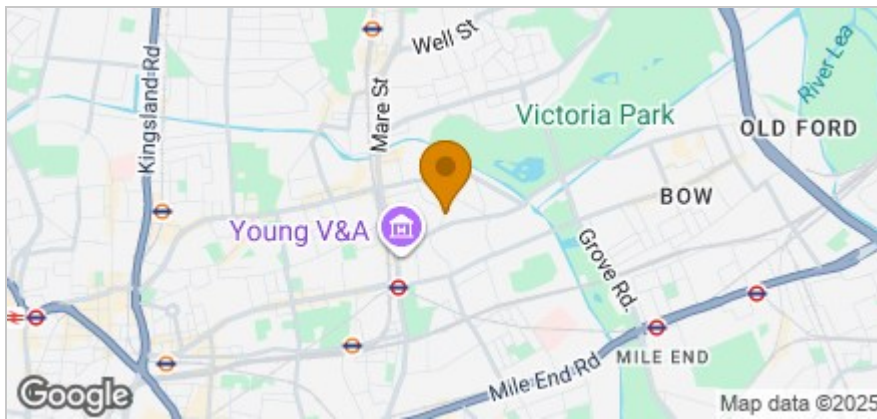

Accommodation

- Beautiful Victorian Conversion
 - Refurbished throughout
 - Eat-In Kitchen
 - Bethnal Green Tube (Central Line Zone 2)
 - Stylish Bathroom Suite
 - 996 Sq. Ft (Split Level)
 - High Ceilings & Sash Windows
 - Victoria Park
 - Lots Of Natural Light (Large Sash Windows)
 - Tree-Lined Street Leading To Victoria Park
- E2

Viewing

Please contact our Storeys of London Office on 0207-096-0666 if you wish to arrange a viewing appointment for this property or require further information.

Energy Efficiency Graph

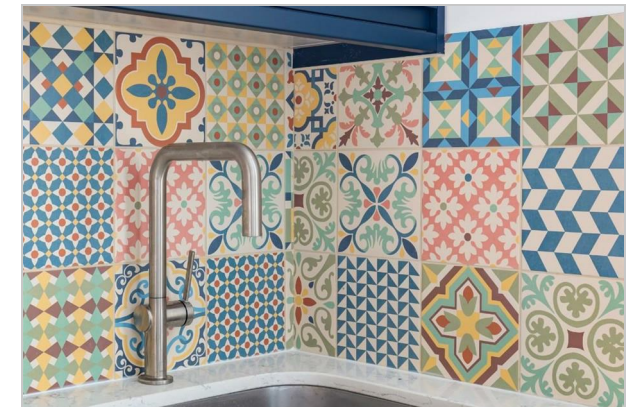
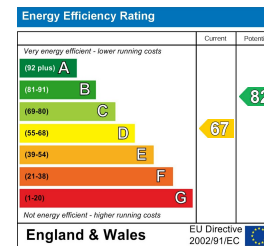

These particulars, whilst believed to be accurate are set out as a general outline only for guidance and do not constitute any part of an offer or contract. Intending purchasers should not rely on them as statements of representation of fact, but must satisfy themselves by inspection or otherwise as to their accuracy. No person in this firm's employment has the authority to make or give any representation or warranty in respect of the property.