

STOREYS



103 Basin Approach, London, E14 7JB
£2,350 Per month

STOREYS

2 2 1 C

Floor Plan

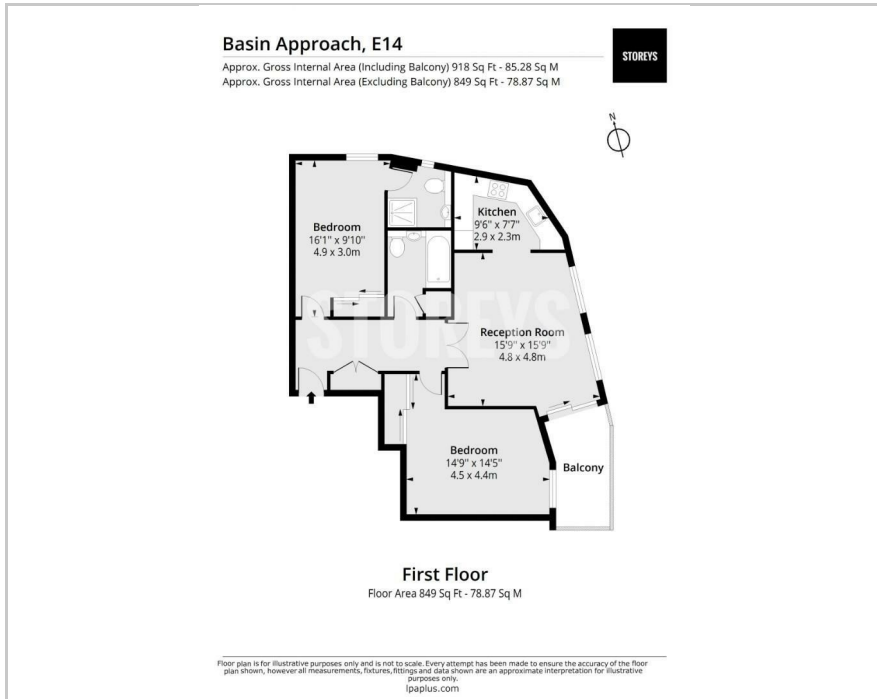

Area Map

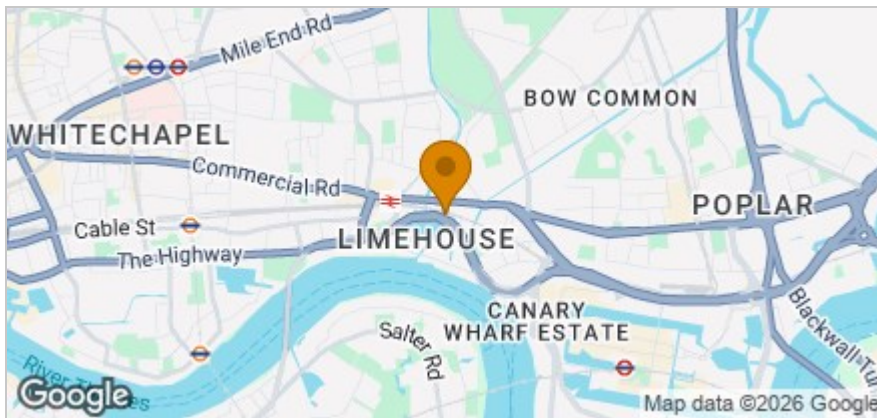

Accommodation

- Private Balcony
- Great Transport Links
- Stunning Views
- Two Bathrooms
- Fully Fitted Kitchen
- Sleek Wooden Flooring
- Furnished Property
- Canary Wharf
- Lift Facilities
- Easy Access Into Canary Wharf

Viewing

Please contact our Storeys of London Office on 0207-096-0666 if you wish to arrange a viewing appointment for this property or require further information.

Energy Efficiency Graph

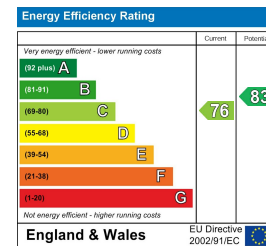

These particulars, whilst believed to be accurate are set out as a general outline only for guidance and do not constitute any part of an offer or contract. Intending purchasers should not rely on them as statements of representation of fact, but must satisfy themselves by inspection or otherwise as to their accuracy. No person in this firm's employment has the authority to make or give any representation or warranty in respect of the property.